

NEW RENOVA HYDRAULIC



1. TECHNICAL SPECIFICATIONS

CHARACTERISTICS	HYDRAULIC
Nominal carload	$180 \leq Q_n \leq 630$ Kg.
Nominal Speed	$V_n = 0.60$ m/s
Type of doors	Manual/Bus type, Automatic Doors
Door width	$500 \text{ mm} \leq \text{Door width} \leq 900 \text{ mm}$
Wireropes	$\varnothing 8-9-11$ mm SDR 6,5 mm.
Guiderails	T-90
Controller	ARCA II (Inclusive of Corrective Measures)
Starts/hour	40-50
Maximum Car travel	21 m

2. MAIN CHARACTERISTICS AND DIMENSIONS

CONDITIONS	
NOMINAL SPEED	0.60 m/s
CAR	180 Kg to 630kg
PIT DEPTH	Minimum 250mm** WITH compensatory measures for EN81-21
	Minimum 1020mm WITHOUT compensatory measures for EN81-21
	Please check with Orona
HEADROOM	Minimum 2800mm WITH compensatory measures for EN81-21
	Minimum 3300mm WITHOUT compensatory measures for EN81-21
SHAFT	Minimum Shaft width: 720 mm
CAR DIMENSIONS	WIDTH (mm): Min 550 / Max 1250
	DEPTH (mm): Min 550 / Max 1400

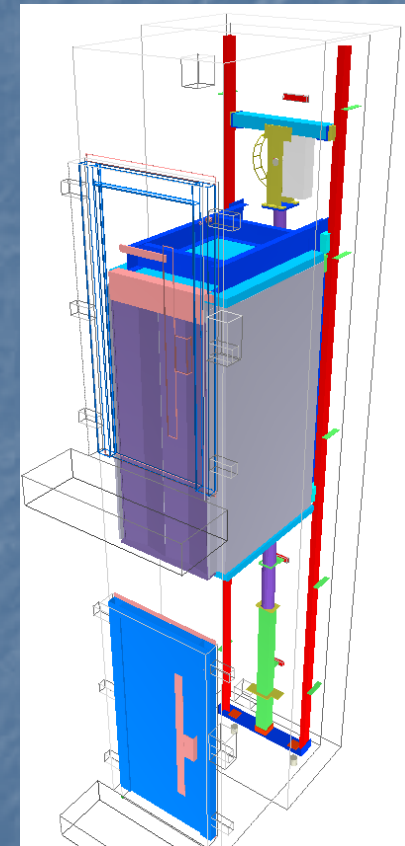

*NB: Above data are applicable to liftcars with one entrance.
For lifts with two entrances kindly check with Orona's Project Engineering Department. **With PVC floor

3. CAR FINISH SPECIFICATIONS

AVAILABLE CAR FINISHES / COP PANEL AND GLASS WALL OPTIONS

CAR LIGHT	REFER TO NEW CATALOGUE	Two types of car light available: * Lighting placed at sides of ceiling * Spot lights
GLASS CAR WALLS	ONLY GLASS ON ONE CAR SIDE WALL IS AVAILABLE	* Glass wall not available on the side of the carguides * Car operating panel not available on the glass wall (Consequently special care should be taken when designing two-entrance lifts with one wall in Glass)
CAR FINISHES	PLEASE CHECK WITH ORONA	

4. PRODUCT DESCRIPTION

CAR FRAME

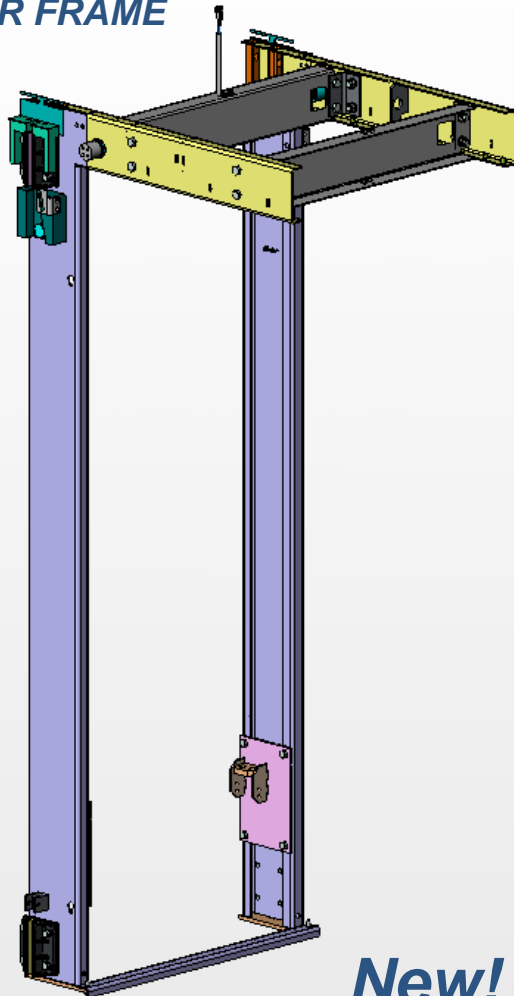

New!

- Carframe incorporated in the car structure
- 2 Options: * Nominal Carload(Q_n) \leq 400 Kg
* Nominal Carload (Q_n) \leq 630 Kg

- Inverted “Rucksack” carframe
- Safety gear at upper side



- *Excellent performance with reduced pit dimensions*
- *Suitable to most available headroom dimensions*

5. ADDITIONAL SPECIFICATIONS

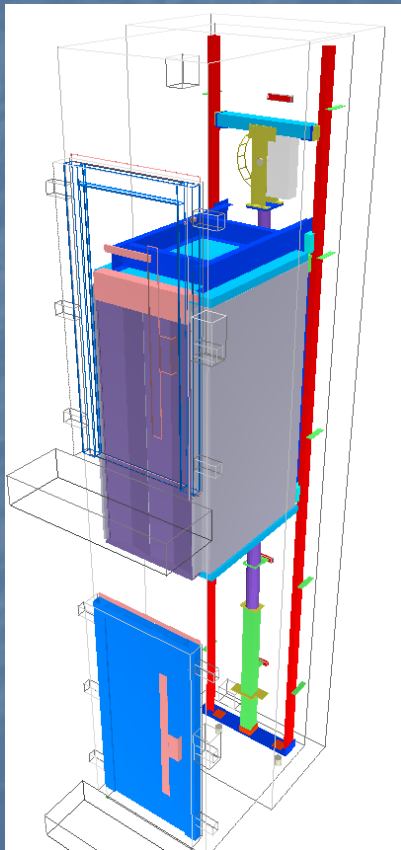

Distance between guides:

- $500 \leq \text{DBG} \leq 1100$

Parallel Pulley

- $400 \leq \text{DBG} \leq 550 \text{ mm}$

(Cross Pulley ,at 90°)

